

Meeting Rooms



Homestead Ballroom

GREAT HALL

The Great Hall conference center offers six separate meeting rooms, ranging from 15 to 400 seats. From the intimate Fireside Room to the historic Great Hall with its giant beams and hand-hewn balconies, there is something for every meeting.

HOMESTEAD

Our largest ballroom, Homestead can be used for larger groups of 600 guests or configured into three smaller rooms, with capacities ranging from a cozy 20-person room to a 300-person room.

SUNRIVER LODGE

Taking cues from the classic national park lodges of the '30s and blended with today's casual sophistication, the Sunriver Lodge features five separate meeting spaces for groups of 10 to 200.

RIVER LODGE GALLERIES

These hospitality suites are perfect for casual group gatherings, with table seating for 12 to 16, club chairs and couches, full kitchen, half bath and patio or balcony looking out on the Meadows Golf Course. Catering is also available.

OUTDOOR MEETING SPACES

See what a little fresh air can do for your thinking with more than 19,000 square feet of outdoor venues—from the Mt. Bachelor Lawn with mountain and golf views, to our Besson Commons, featuring bocce ball courts and fire pits.

TECHNOLOGY SERVICES

Wi-Fi a/b/g/n/ac in all Resort guest public spaces, meeting rooms and guest rooms

10 Mb upload/10 Mbps download speed

Wired and wireless ethernet available in all meeting rooms

Audio/Visual Services, including data and video projection, sound system, computers, lighting and teleconferencing

Guest Internet kiosk at the business center

Video conferencing available by request

GREAT HALL

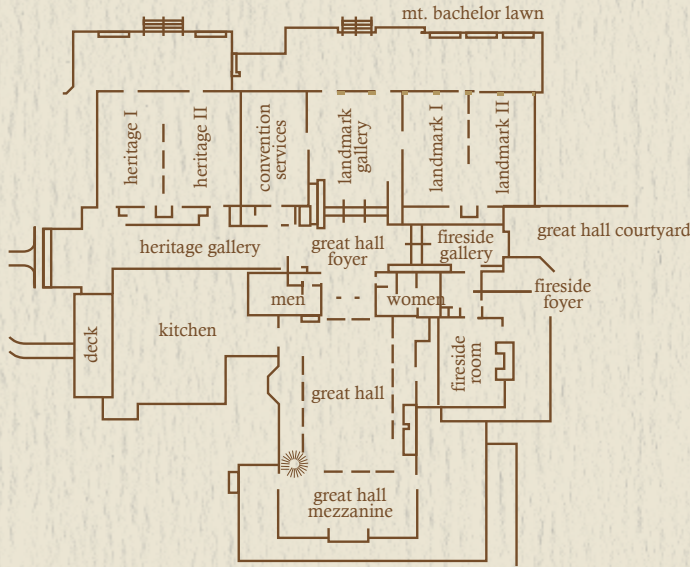

room	sq ft	classroom	theater	banquet	reception	conference	U-shape	t.t. exhibits
great hall	5,650	250	400	376	500	-	-	-
great hall main floor	3,600	220	300	280	-	48	56	42
great hall mezzanine	2,050	35	100	96	-	-	-	29
great hall courtyard	4,500	-	-	150	400	-	-	-
landmark I	900	60	60	50	90	30	30	15
landmark II	900	60	60	50	90	30	30	15
landmark I & II	1,800	120	120	120	180	48	40	30
landmark gallery	918	-	-	-	130	-	-	10
fireside room	672	24	45	45	60	20	24	10
fireside gallery	168	-	-	-	20	-	-	3
heritage I	828	36	70	50	90	28	26	14
heritage II	1,008	48	90	60	90	28	28	15
heritage I & II	1,836	114	162	120	180	56	56	29
heritage gallery	1,296	-	-	-	175	-	-	14
mt. bachelor lawn	1,360	-	200	150	200	-	-	-

HOMESTEAD

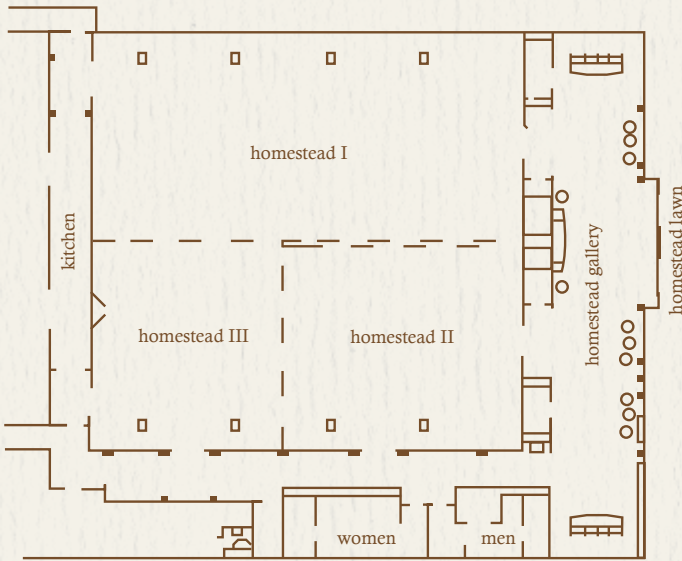

room	sq ft	classroom	theater	banquet	reception	conference	U-shape	t.t. exhibits
homestead	6,560	330	600	475	656	-	-	85
homestead I	3,280	171	300	213	325	-	85	43
homestead II	1,840	84	160	110	180	40	48	22
homestead III	1,440	60	120	96	150	35	40	20
homestead II & III	3,200	165	310	206	325	-	85	42
homestead lawn	3,300	-	-	250	360	-	-	-
homestead gallery	1,710	-	-	-	-	-	-	7

SUNRIVER LODGE

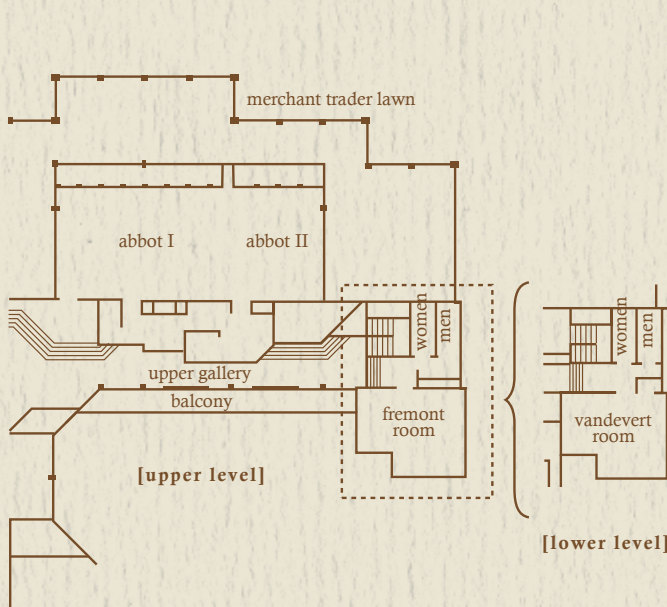

room	sq ft	classroom	theater	banquet	reception	conference	U-shape	t.t. exhibits
abbot	2,130	106	149	142	280	60	56	46
abbot I	1,440	74	102	96	200	40	36	19
abbot II	690	32	47	46	80	20	20	13
fremont/vandevent	644	21	35	40	40	20	20	-
merchant trader lawn	9,720	-	-	470	770	-	-	-
hearth room	1,206	24	60	50	60	24	24	10
carson's kitchen dining room	-	-	-	80	100	-	-	-
twisted river tavern patio	-	-	-	40	50	-	-	-

OTHER ROOMS/SPACES

room	sq ft	classroom	theater	banquet	reception	conference	U-shape	t.t. exhibits
besson commons	10,000	-	-	400	600	-	-	-
river lodge galleries(2)	576	-	-	-	30	14	-	12