

THE LODGE

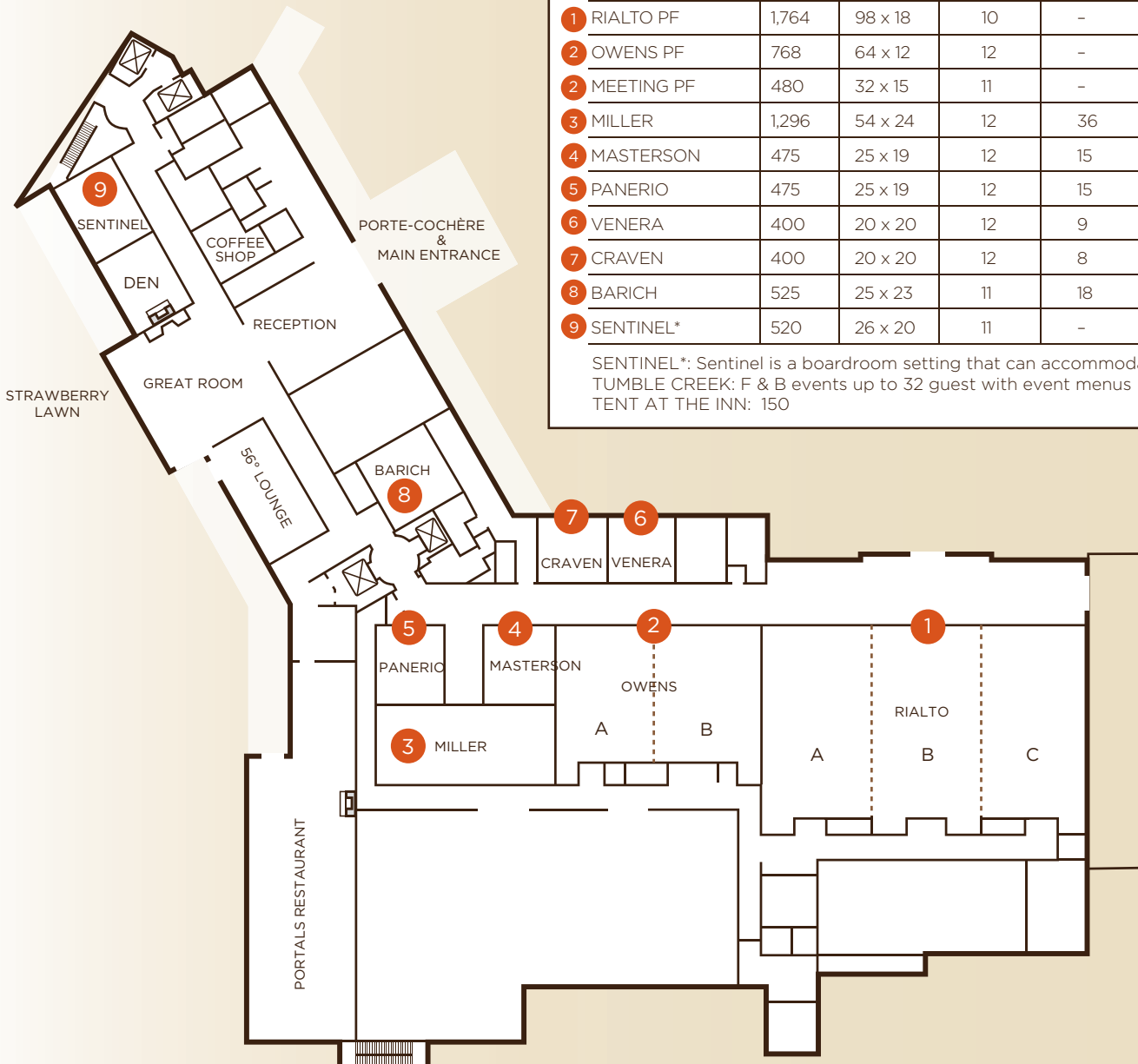

| ROOM | SQ. FT. | L x W | CEILING | U-SHAPE | CONFERENCES | CLASSROOM | THEATER | BANQUET | RECEPTION |
|---------------------|---------|---------|---------|---------|-------------|-----------|---------|---------|-----------|
| 1 RIALTO | 5,940 | 99 x 60 | 17 | 102 | - | 324 | 528 | 400 | 550 |
| 1 RIALTO A | 1,920 | 32 x 60 | 17 | 45 | - | 108 | 144 | 120 | 125 |
| 1 RIALTO B | 2,220 | 37 x 60 | 17 | 46 | - | 108 | 182 | 140 | 140 |
| 1 RIALTO C | 1,920 | 32 x 60 | 17 | 45 | - | 108 | 144 | 120 | 125 |
| 1 RIALTO A/B or B/C | 4,080 | 68 x 60 | 17 | 57 | - | 216 | 384 | 240 | 200 |
| 2 OWENS | 2,688 | 64 x 42 | 12 | 51 | - | 120 | 240 | 170 | 170 |
| 2 OWENS A or B | 1,386 | 33 x 42 | 12 | 33 | 24 | 72 | 108 | 80 | 80 |
| 1 RIALTO PF | 1,764 | 98 x 18 | 10 | - | - | - | - | - | 221 |
| 2 OWENS PF | 768 | 64 x 12 | 12 | - | - | - | - | - | 96 |
| 2 MEETING PF | 480 | 32 x 15 | 11 | - | - | - | - | - | 60 |
| 3 MILLER | 1,296 | 54 x 24 | 12 | 36 | 30 | 72 | 96 | 80 | 75 |
| 4 MASTERSON | 475 | 25 x 19 | 12 | 15 | 14 | 18 | 35 | 30 | 30 |
| 5 PANERIO | 475 | 25 x 19 | 12 | 15 | 14 | 18 | 35 | 30 | 30 |
| 6 VENERA | 400 | 20 x 20 | 12 | 9 | 12 | 12 | 24 | 20 | 20 |
| 7 CRAVEN | 400 | 20 x 20 | 12 | 8 | 12 | 12 | 24 | 20 | 20 |
| 8 BARICH | 525 | 25 x 23 | 11 | 18 | 22 | 27 | 40 | 30 | 30 |
| 9 SENTINEL* | 520 | 26 x 20 | 11 | - | - | - | - | - | - |

SENTINEL*: Sentinel is a boardroom setting that can accommodate 16 guests.
 TUMBLE CREEK: F & B events up to 32 guest with event menus
 TENT AT THE INN: 150